

FOR LEASE

4118 Will Rogers Parkway Suite 200 Oklahoma City, OK 73108



- TOTAL SIZE 10,022 SF
- OFFICE SIZE BTS 1,200 SF
- CLEAR HEIGHT 18'
- BAY DEPTH 139' 9"
- COLUMN SPACING 36' 3"
- DOCK DOORS 1
- RAMPS 1
- 160 FOOT TRUCK COURT
- EASY ACCESS TO I-40, I-35, & I-44
- NEGOTIABLE RATE

HORIZON COMMERCIAL REAL ESTATE

DAVID PORTMAN, CCIM
PRINCIPAL

405.850.1107
david.portman@horizoncreok.com

FOR LEASE

4118 Will Rogers Parkway Suite 200 Oklahoma City, OK 73108

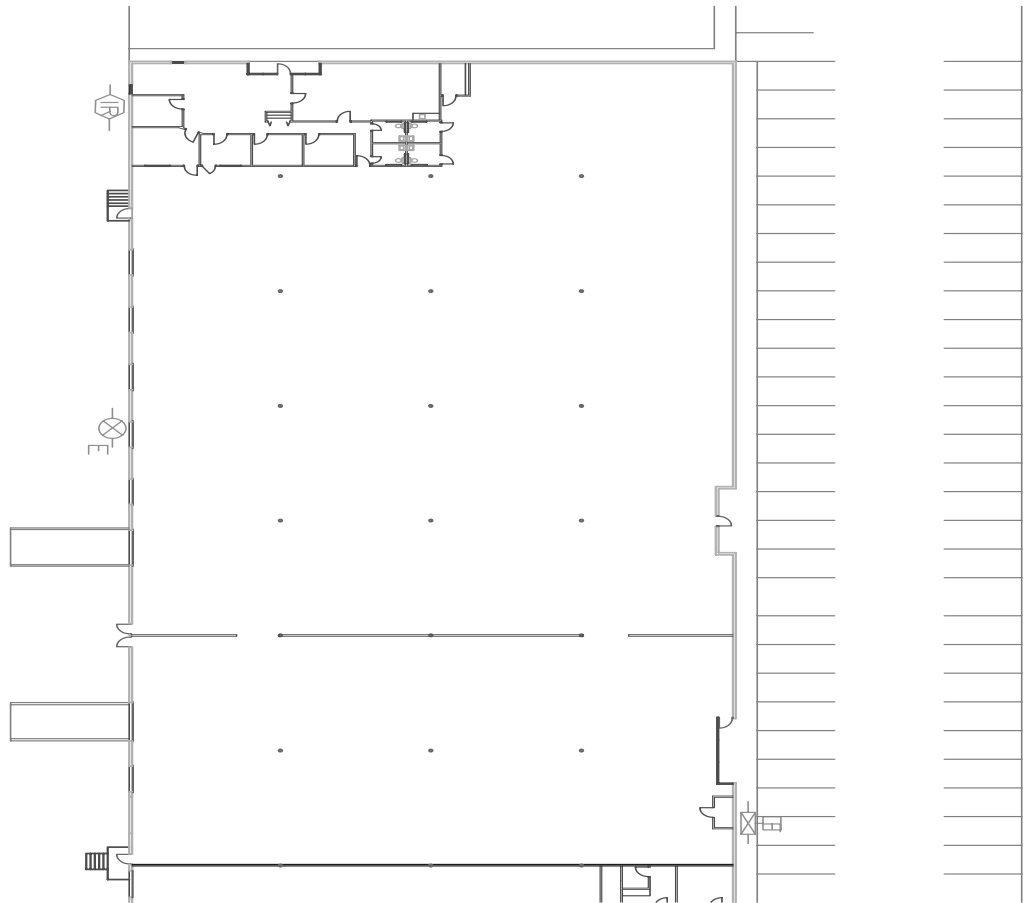

HORIZON COMMERCIAL REAL ESTATE

DAVID PORTMAN, CCIM
PRINCIPAL

405.850.1107
david.portman@horizoncreok.com

FOR LEASE

4118 Will Rogers Parkway Suite 200 Oklahoma City, OK 73108



HORIZON COMMERCIAL REAL ESTATE

DAVID PORTMAN, CCIM
PRINCIPAL

405.850.1107

david.portman@horizoncreok.com

